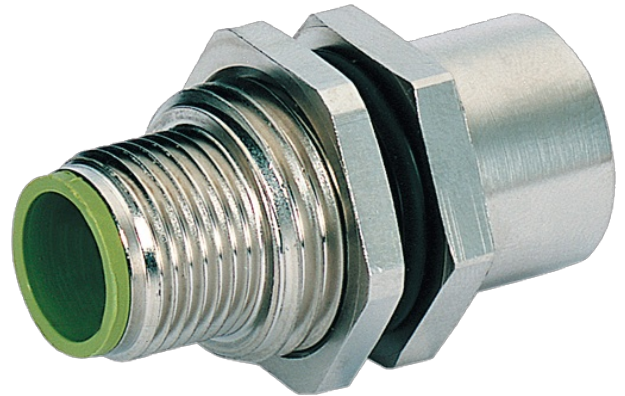

M12-PANEL FEED THROUGH 5 POLE B-CODED

Control cabinet entry system
 Male - female
 M12, 5-pole
 B-coded
 shielded

Illustration

Product may differ from Image

Form

Form	44111
------	-------

Technical Data

Operating voltage	max. 60 V AC/DC
Rated surge voltage	1.5 kV
Operating current per contact	max. 4 A
Material group	IEC 60664-1, category I
Coding	B-coded
Locking of ports	Screw thread (M12×1 mm) recommended torque 0.6 Nm, self-securing
Protection	IP65 and IP67 when plugged and screwed down (EN 60529)
Material	Brass, nickel plated

General data

Pollution Degree	2
Mounting set	M16×1.5 mm
Temperature range	-25...+85 °C

Commercial data

country of origin	CZ
customs tariff number	85366990
EAN	4048879141420
eClass	27279220
Packaging unit	1

Sketch

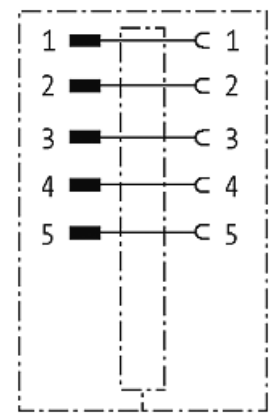
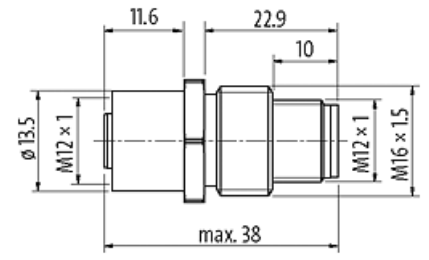
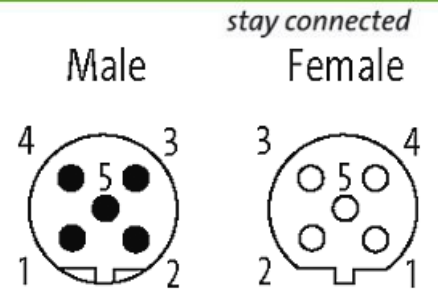

Product may differ from Image